



Quick Start Guide

REDFLY SPECIFICATIONS

| | |
|-----------------------|---|
| Display | 800x480 |
| VGA Port | 800x480 WVGA maximum resolution |
| USB Ports | 2x2.0 powered (500mA maximum) |
| Bluetooth | Compatible with Bluetooth 1.0 and 2.0. 30 feet (10 meters) maximum range, 1Mbps maximum throughput |
| Weight | 2 lbs (2 lbs, 4 oz. with adapter) .9 Kilograms (1.02 Kg. with adapter) |
| Battery | 7.4V, 4500mAh, Lithium Polymer Battery Avg. 3 hours to fully charge the battery |
| OS Support | Selected Windows Mobile phones Visit www.celiorcorp.com/smartphone for a list of supported phones |
| Operating Temperature | 32 – 104 degrees F (0 – 40 degrees C) |
| Charger | 9VDC 2.5A LiPo-compatible |

CUSTOMER SUPPORT

Please check out our support page at www.celiorcorp.com/support for answers to your REDFLY questions and help options.



© Copyright 2008 Celio Corp. Celio, REDFLY, the REDFLY logo, and other indicia are all trademarks or registered trademarks of Celio Corp. All rights reserved. Patent Pending. www.celiorcorp.com

The Bluetooth® word mark and logo are registered trademarks owned by the Bluetooth SIG, Inc.

Welcome

1

Welcome to REDFLY—the Essential Windows Mobile Smartphone Companion

You are minutes away from enjoying the liberating power of the REDFLY's larger keyboard, wide screen, and enhanced environment for your Windows Mobile smartphone!

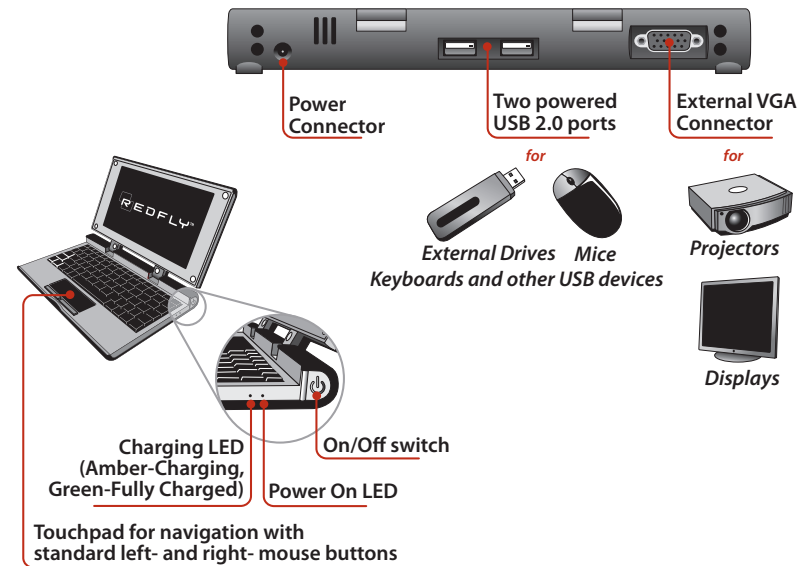

Install the REDFLY Software

2

To setup your REDFLY for the first time, you will need:

1. Your Windows Mobile smartphone with an active Internet connection OR a PC with Microsoft ActiveSync (called "Windows Mobile Device Center for Microsoft Vista" on Vista systems) and an Internet connection.
2. Your smartphone's USB connecting cable. (Contact your local retailer for a replacement if you do not have this cable.)
3. Your REDFLY.

Remove the protective plastic film from your REDFLY display. For best results, plug in your REDFLY to the AC adapter and allow at least 3 hours to fully charge the battery.

OVER THE AIR SETUP

Note: Cell phone data rates will apply to this download.

1. Use your smartphone browser to go to: <http://www.celiorcorp.com/install/mobile>
2. Select the *Over the Air Installation* link.
3. Accept the End User License Agreement and click **Download**.
4. Confirm that the box marked *Open File After Download* is checked.
5. Click **Yes** to download and run the install file on your smartphone.
6. Follow the onscreen directions to complete the installation.

Install the REDFLY Software

3

INSTALLING FROM YOUR COMPUTER

You can also setup the REDFLY using your PC with an Internet connection. This requires Microsoft ActiveSync (or "Windows Mobile Device Center for Microsoft Vista") on your PC. (If you have not used ActiveSync or Device Center before, please refer to your phone's manual for instructions.)

1. Run ActiveSync (or Device Center) on your PC.
2. Power on your smartphone and connect it to your PC using your USB connecting cable. ActiveSync (or Device Center) will automatically find your phone and say "Connected".
3. Use your PC browser to go to: <http://www.celiorcorp.com/install>
4. Select the *Installing From Your Computer* link.
5. Accept the End User License Agreement and click **Download**.
6. Click **Run**.
7. Click **Run** again.
8. If you want to include the *REDFLY User's Guide* in your download, check the box. (This will place a copy of the Guide in the My Documents folder on your PC.)
9. Click **Install**.
10. Follow the onscreen instructions on your PC and your phone to complete the installation.

Connecting the REDFLY

4

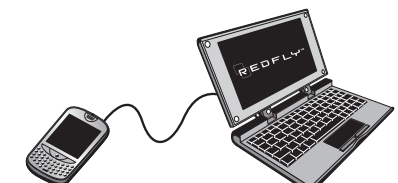
1. Power on your phone.
 2. Power on your REDFLY.
- 
3. Attach your USB connecting cable to your phone and the REDFLY.
- 

Your phone will automatically detect the connection to the REDFLY and switch your phone's display and keyboard functions to the REDFLY.

Setting up Bluetooth

5

You now have the option to activate the REDFLY's Bluetooth feature.

SETTING UP BLUETOOTH FOR THE FIRST TIME ("PAIRING")

1. Turn on your phone's Bluetooth connection. (Refer to your phone's manual for details.)
2. On non-touchscreen phones, enable Bluetooth Discovery. (Some phones call this "make this device discoverable".)
3. Connect your REDFLY to your smartphone using the USB cable.
4. Press the REDFLY logo key on the REDFLY keyboard to open the Settings window.
5. Select the Bluetooth tab at the top of the screen. Your REDFLY's Bluetooth address appears in the *Currently Connected REDFLY* address box.
6. Click the *Authorize* button. Your REDFLY's address now appears in the Authorized list.
7. Click OK.
8. Press the Bluetooth/F12 key.

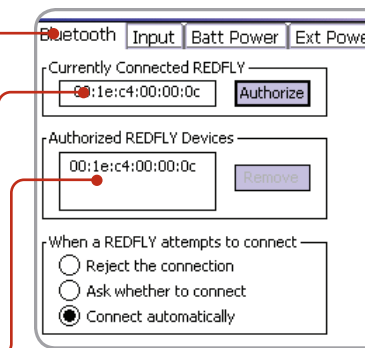

Setting up Bluetooth

6

Your phone and your REDFLY are now paired. The REDFLY software will automatically switch from the USB to the Bluetooth connection.

The REDFLY "System Tray" will also display a Bluetooth signal strength meter.



You can now disconnect the USB cable and work using Bluetooth.

USING BLUETOOTH

Once you have "paired" your smartphone and REDFLY over Bluetooth, connecting wirelessly the next time is almost automatic.

1. Power on your smartphone and activate Bluetooth.
2. Power on the REDFLY.
3. Press the Bluetooth/F12 key.

The REDFLY will connect to your phone via Bluetooth. Your phone will switch the display to the REDFLY.



Caution: The REDFLY supports USB drives on its external ports. Be careful when saving data to an external USB drive while on Bluetooth. If you move out of the range of the Bluetooth signal with the REDFLY, you may lose your connection to your phone. If your phone is saving data to that USB drive, this disconnect could result in the loss of data or a corrupted USB drive.

Using the REDFLY is as simple as using your smartphone—because it is your smartphone! E-mail, voicemail, contact management, and all the other familiar Windows Mobile features act exactly the same, so there's no learning curve.

USING ALT-TAB

You can use the ALT-TAB keys to toggle between active programs on your phone. Press ALT-TAB on the keyboard to display the active program icons. Hold the ALT key down, then press and release the TAB key to move between the icons to highlight the one you want. Release both keys to go to that program.

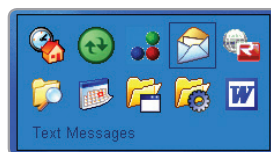

SMARTPHONE (NON-TOUCHSCREEN) NAVIGATION

Your REDFLY's trackpad and mouse buttons can function like the five-way navigator on your smartphone or as they normally would on a PC. To activate the five-way option:



1. Click both the left and right mouse buttons together. The navigator icon appears in the center of the REDFLY screen.
2. Move your finger left or right, up or down on the trackpad to navigate the onscreen highlight to make your selection.
3. Tap once on the trackpad with your finger to accept an option or selection as you would the Enter (center) button on your smartphone navigator.

To turn off the five-way option, simply click both the left and right mouse buttons again.

Use the REDFLY's ESC and Back Space keys like the BACK key on your smartphone to go back a screen.

TOUCHSCREEN PHONE NAVIGATION

Use the trackpad and mouse buttons as you would on a PC to select onscreen items. To replicate your phone's "Tap and Hold" onscreen action, place your cursor on an object then press and hold the REDFLY's left mouse button.

MAKE A CALL

To make a call:

1. Press the SEND key on the REDFLY or on your phone. This brings up the keypad onscreen.
2. Use the cursor and touchpad or the keyboard to dial the number. (You can also use Call History, Speed Dial, or your Contacts feature to dial numbers.)
3. Use your handset, Bluetooth headset*, or the speakerphone option on your phone to talk.

Note: Your phone's earpiece and microphone become active when you dial a call on the REDFLY.

When you finish your call, press the END key on your phone or the REDFLY.

RECEIVE A CALL

When you receive a call while using the REDFLY, your phone's Incoming Call screen appears. To answer the call:

1. Press the SEND key on the REDFLY or on your phone.
2. Use your handset, Bluetooth headset, or speakerphone option to talk.

When you finish your call, press the END key on your phone or the REDFLY.

** Bluetooth phones and headsets vary widely in their performance particularly when using two such connections simultaneously: one between your phone and a headset and one between your phone and the REDFLY. Doing so may cause poor audio quality or a Bluetooth disconnect.*



DISCONNECTING FROM THE REDFLY

When you are ready to end your session with your REDFLY, you can disconnect and reactivate your smartphone display in one of three ways:

1. Unplug the USB cable.
2. If you are on Bluetooth, press the Bluetooth/F12 key on the REDFLY.
3. Power off the REDFLY.



DISPLAY ICONS

Move your cursor to the bottom right of the display to reveal the REDFLY's "System Tray" with icons for connection type, battery status, and Caps/Num Lock.



| REDFLY Tray Icon | Symbol |
|------------------------|------------------------|
| Caps Lock | Red capital letter "A" |
| Num Lock | Red numeral "1" |
| Battery Charging | |
| Battery Fully Charged | |
| Battery 1/2 Charged | |
| Battery Needs Charging | |
| USB 1.1 Connection | |
| USB 2.0 Connection | |
| Bluetooth Connection | |
| No Phone Connected | |

SMARTPHONE CHARGING

The REDFLY can charge your smartphone if your phone is connected using USB and the REDFLY is on (and your phone supports charging over USB).

Here are some tips to get the most from your REDFLY.

REGISTER YOUR REDFLY

Go to <http://www.celiocorp.com/registration> to register your REDFLY to get the latest updates.

DOWNLOAD THE REDFLY USER'S GUIDE

The REDFLY User's Guide details how to use the many features of the REDFLY. Download it from www.celiocorp.com/support.

BROWSING THE INTERNET

Microsoft's Pocket Internet Explorer is delivered with every Windows Mobile smartphone. Alternatively, Opera offers an excellent browser for mobile devices that can improve your web experience: Web search for "Opera Mobile download" or go to www.opera.com/products/mobile/products/.

PDF READER

Adobe offers a PDF reader that is optimized for mobile devices. Web search for "Adobe Reader for Pocket PC version 2.0" or go to <http://www.adobe.com/products/acrobat/acrrppcdload.html>.

BLUETOOTH AND USB CONNECTIONS

Running basic office and email applications works very well when connected via Bluetooth. Applications that require more graphics-intensive or interactive content may work better via a USB connection.

1. Easily move between multiple active applications using the ALT-TAB keys.
2. Connect to your phone easily using Bluetooth.
3. Quickly enter numeric data using the embedded keypad.
4. Really see the web on your browser with the larger screen.
5. Rapidly touch type answers to e-mails.
6. Instantly add an external keyboard or mouse to your phone.
7. Quickly share presentations with the built-in VGA port.
8. Expand your memory options using standard external flash drives.
9. Stay productive with Mobile Office apps on the larger screen and keyboard.
10. Enjoy the lightweight companion with desktop features and phone portability.

Try the power and abilities of the REDFLY compared with a phone alone. On the REDFLY, open your browser to a conference website, then open Windows Mobile Messaging. Use Alt-Tab to move between the browser and Messaging to send an e-mail about the various sessions.

Receive a phone call and type in notes while talking.

Open a spreadsheet and use the embedded keypad to update it with the latest sales figures. Open a Power Point presentation. Connect a projector. Use ALT-TAB to switch between Power Point and the updated spreadsheet for your audience.

Q: *When I connect to the REDFLY using USB, the REDFLY displays an error message.*

A: Some phones don't automatically set the appropriate type of connection for the REDFLY. To fix this:

1. Go to your smartphone's Start/Settings screen (on some phones go to the Start/Programs screen).
2. Choose Connections (on some phones, choose Accessory).
3. Choose USB to PC (on some phones, choose USB Switch).
4. Make sure that the box "Enable advanced network functionality" is checked. If not, mark the box and click Ok to accept the change. (Some phones may call this option "Enable RNDIS".)

Q: *I have connected my REDFLY to my phone, but nothing happens when I press the buttons on the keyboard.*

A: Check to be sure your phone is not locked. If your phone is locked, the REDFLY will connect but it will not allow access to applications.

Q: *I tried running Bluetooth on the REDFLY but the message appears "Can't Connect. Not paired with a phone."*

A: You have not paired this particular phone to your REDFLY. You will need to follow the steps on Setting Up Bluetooth to complete the pairing and use Bluetooth.

Q: *When I install the REDFLY software on my Motorola Q, it does not automatically reset.*

A: If you have your Motorola Q plugged into USB or AC power, you'll need to manually power up your phone after installing the REDFLY software

Q: *My Today screen background does not appear correctly on the REDFLY.*

A: Some phones do not correctly render the Windows Mobile Default background on the REDFLY. Use Guava Bubbles, Green, or a custom image as your background instead.

The REDFLY keyboard provides shortcuts to frequently used applications or preferences.

Home: This key opens your Today menu.

OK: Selects an onscreen option, change, or preference like the OK key on your phone.

Mail: This launches Windows Mobile Messaging.

Brightness Decrease/Increase: F9 dims and F10 brightens your REDFLY display.

Web: This launches Internet Explorer.

External Monitor: Opens the REDFLY Display menu. You can then select to use a projector or both the REDFLY screen and a projector connected to the VGA port.

SEND: Acts like the Send key on your smartphone

END: Acts like the End key on your smartphone.

Bluetooth: This key activates or deactivates the REDFLY's Bluetooth connection with your phone.

L MENU: Activates the current application's left menu.

REDFLY: This key brings up the REDFLY Settings screen.

R MENU: Activates the current application's right menu.

To use your REDFLY safely:

- Do not use the REDFLY while operating a motor vehicle.
- Do not use the Bluetooth connection near any medical device sensitive to radio (RF) transmissions.
- Do not use Bluetooth in any location where posted notices require this (such as "Turn off two-way radio").

FCC, CE AND CSA COMPLIANCE STATEMENT

This device complies with appropriate government radio frequency rules and regulations. Please see the REDFLY User's Guide or the Celio Corp. website for further information. This product complies with Part 15 of the FCC rules. Operation is subject to the following conditions: (1) This device may not cause harmful interference, (2) This device must accept any interference received including interference that may cause undesired operation.

